

POTTERS BAR
149 High Street, Potters Bar EN6 5BB
Tel: 01707 657181
Email: pottersbar@andrewward.co.uk

BROOKMANS PARK
35 Bradmore Green, Brookmans Park AL9 7QR
Tel: 01707 649779
Email: brookmanspark@andrewward.co.uk

BARNET
175 High Street, Barnet EN5 5SU
Tel: 020 8441 6000
Email: barnet@andrewward.co.uk

www.andrewward.co.uk
175 High Street, Barnet, Herts, EN5 5SU
020 8441 6000 | barnet@andrewward.co.uk

Contact us

Our Offices

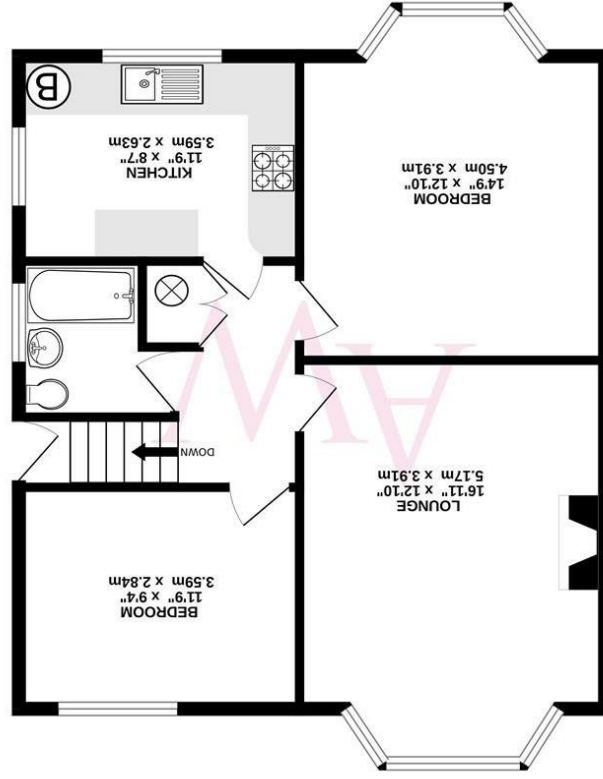

These views are intended to provide a general impression of the property and are not intended to be a contract. Measurements are given as approximate and are not intended to be a contract. No survey or testing of appliances has been carried out. No employee of Andrew Ward Estate Agents has the authority to make or give any representation or warranty in respect of the property.



2 ESMOND COURT PROSPECT ROAD, BARNET EN5 5AJ

Offers In Excess Of £425,000 | Leasehold



Property Overview

Introducing this well presented 1962 purpose built large two double bedroom first floor maisonette In Esmond Court which is situated on the highly desirable tree lined Prospect Road. The property comprises of a bright and spacious living room with bay window and feature fire place. Separate dual aspect shaker style kitchen which enjoys superb elevated views over Barnet, big master bedroom with fitted wardrobes a second double bedroom and a fully tiled three piece suite family bathroom. To the rear of the property is a good sized beautifully landscaped westerly facing private garden with sun trap patio and shed.



Property Features

- LIVING ROOM - 17'7 X 12'9
- KITCHEN - 12'0 X 8'3
- BATHROOM
- PRIVATE GARDEN
- BEDROOM 1 - 15'1 X 12'10
- BEDROOM 2 - 11'8 X 9'4
- EXCELLENT LOCATION

Agents Notes

Sold with a brand new 157 year lease on completion. Also includes a large loft.

Esmond Court is situated in Prospect Road between Abbots Road and Highlands Road and is therefore within close proximity to the multiple shopping facilities at Barnet town centre, a wide range of restaurants and cafe's and both High Barnet (Northern Line) underground station and New Barnet (Mainline) station.